

4' Classic Poly Glider

- (A) - Seat Assembly
- (B) - Back Assembly
- (C) - Glider Base right side
- (D) - Glider Base left side
- (E) - Bearing Supports
- (F) - Head Board
- (G) - Armrest Assembly right side
- (H) - Armrest Assembly left side
- (I) - Crosspiece Support
- (J) - Lintels
- (K) - Front & Back Crosspieces

Hardware

- 2 - 5/16" x 4" Bolt
- 2 - 5/16" x 3" Bolt
- 6 - 5/16" x 2 1/2" Bolt
- 4 - Large Nut (3/8")
- 10 - Small Nut (5/16")
- 28 - Washer
- 8 - 2 1/2" Screws
- 44 - 2" Screws
- 8 - 1/2" Screws

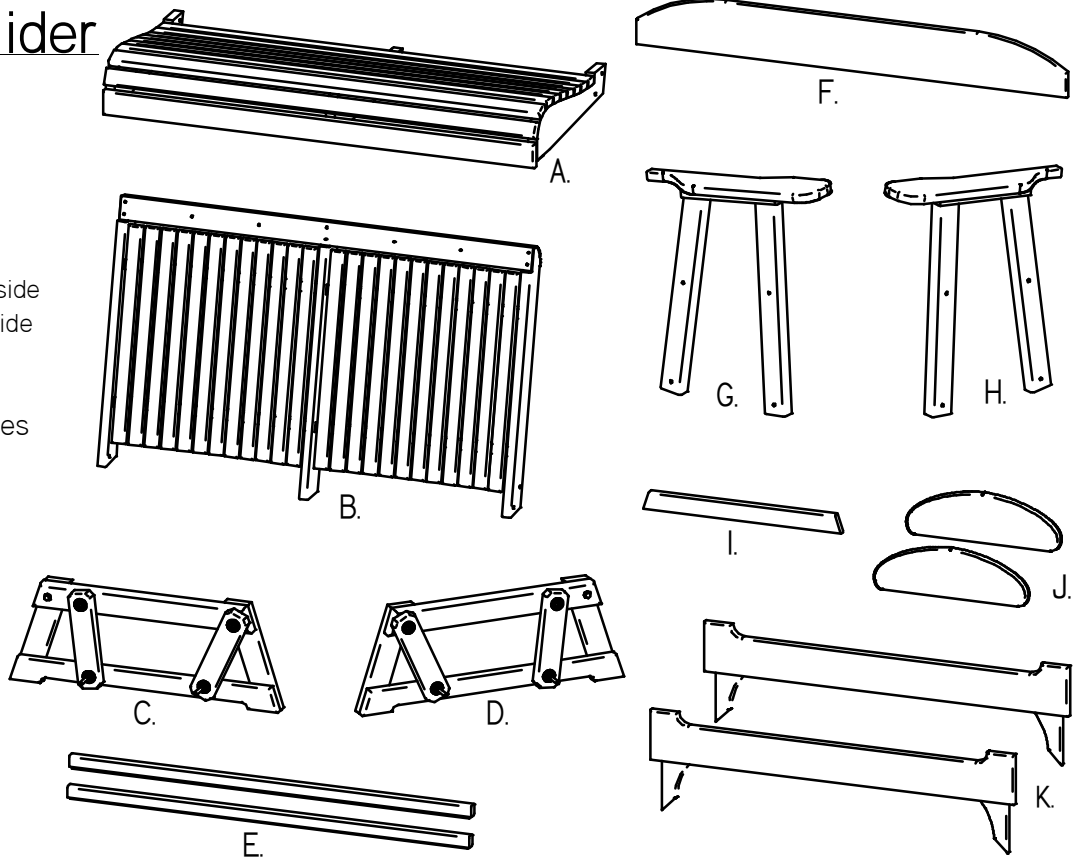

1. Attach (K) Front Crosspiece to Glider Base Sides using fourteen 2" Screws.

"Be sure to match all letters and/or numbers"

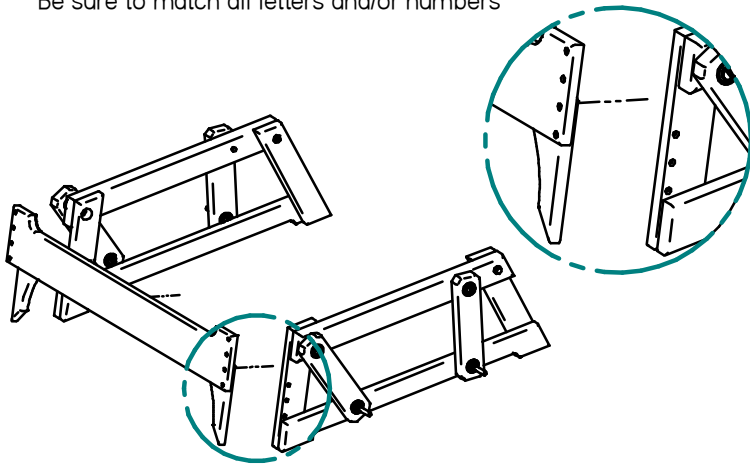

2. Attach (K) Back Crosspiece to Glider Base Sides using fourteen 2" Screws.

"Be sure to match all letters and/or numbers"

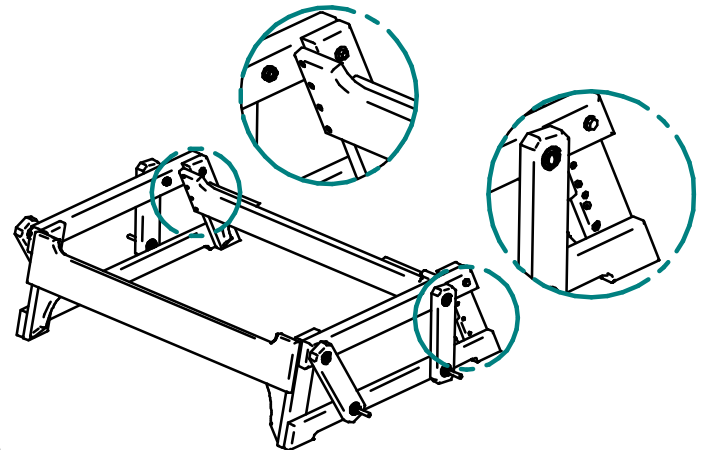

3. Attach (I) Crosspiece Support between Crosspieces and attach using four 2" Screws.

"Be sure to use all letters and/or numbers"

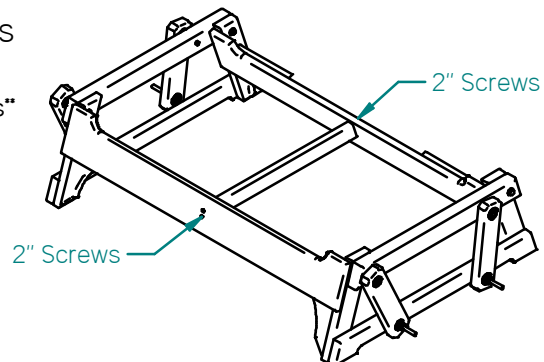

4. Attach (E) Bearing Supports to Glider Base Bearing Arms using four 2 1/2" Screws on each side.
 "Be sure to match all letters and/or numbers"

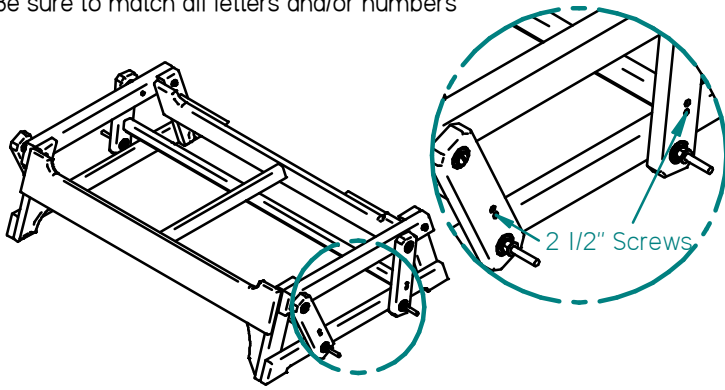

5. Attach Armrest Assemblies to each side.
 Assembly order is: Washer - Armrest Assembly - Washer - Large Nut

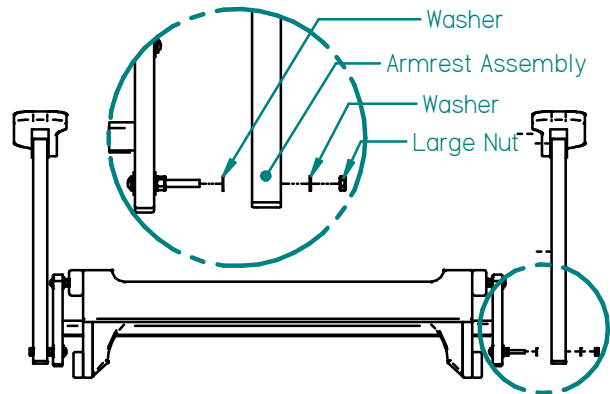

6. Attach (F) Headboard to (B) Back Assembly using eight 1/2" screws on backside.

"Be sure to match all letters and/or numbers"

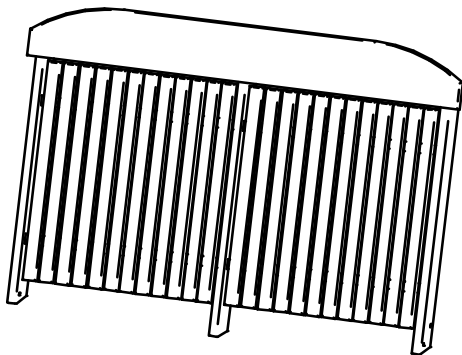

7. Attach (A) Seat Assembly to (B) Back Assembly using four 2 1/2" Bolts. Use two bolts in center support and one in top hole per outside supports.
 "Be sure to match all letters and/or numbers"

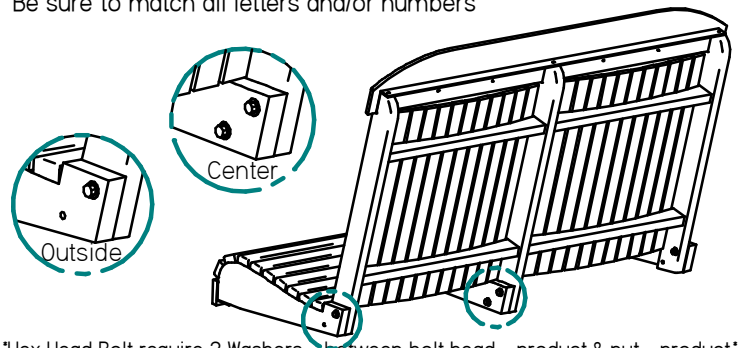

Hex Head Bolt require 2 Washers - between bolt head - product & nut - product

8. Slide assembled Seat & Back between Armrests and install 4" Bolts in back upright and bottom hole of seat assembly on each side.

"Be sure to match all letters and/or numbers"

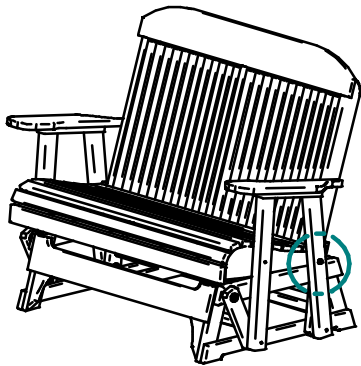

Hex Head Bolt require 2 Washers - between bolt head - product & nut - product

9. Attach seat to front leg using 3" Bolts and Armrest to back support using 2 1/2" Bolts.
 Repeat on opposite side.

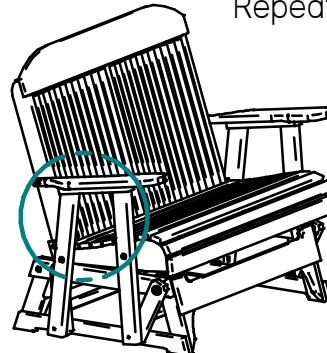

Hex Head Bolt require 2 Washers - between bolt head - product & nut - product

10. Attach (J) Lintels to each side using 2" Screws.
 "Be sure to match all letters and/or numbers"

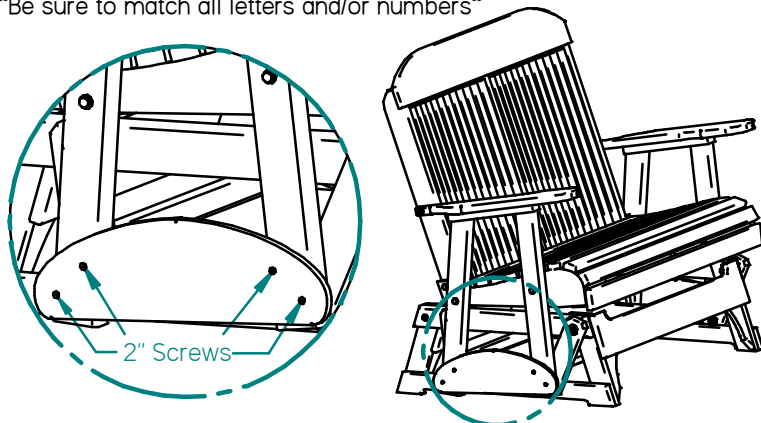

Premium Poly Patios
 Eco-Friendly Furniture For a 'World of Difference!'
 Toll Free 1-877-904-1234
www.Poly-Lumber-Furniture.com